

Manchester Transport Museum  
Heaton Park  
Manchester  
M25 5SW



**Website**  
www.heatonparktramway.org.uk  
**Email**  
heatonparktramway@hotmail.co.uk  
**Tel**  
0161 740 1919 or 01282 436 802



# Depot Appeal

The MTMS has a number of tramcars currently in storage in various locations. We have had planning permission approved for a new depot in which to house them. The Society needs to raise £30,000 for the project and we need your help!

Initial work is already underway, with ground cleared and contractors contacted. We are keen to complete the project as soon as possible, but cannot go ahead unless sufficient funds are forthcoming. This depot is essential for the growth of the Society. It will house sufficient vehicles to operate any future extensions.

You can help now, either by using paypal on the website or by post.

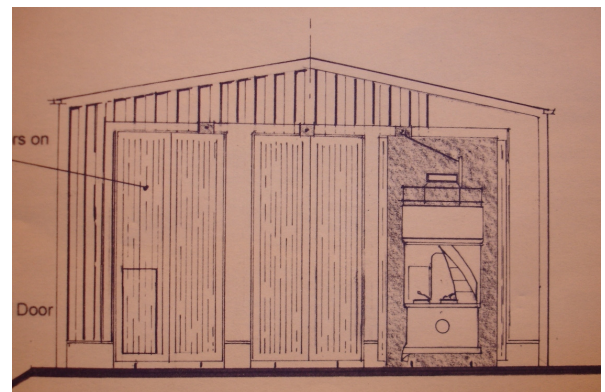
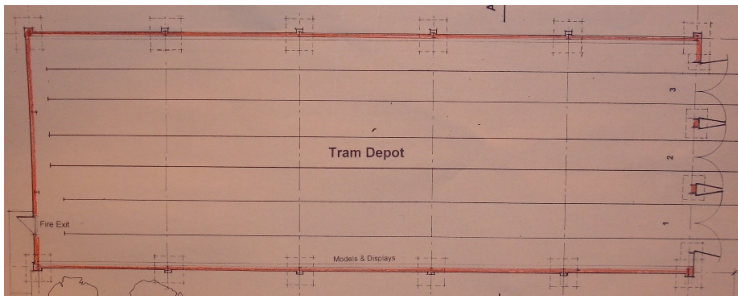

Please use **BLOCK CAPITALS** to complete this form:

To: Mr J Valentine, MTMS, 34 Fountains Rd, Cheadle Hulme, Cheadle, Cheshire, SK8 7PY

I wish to make a donation of £ \_\_\_\_\_ towards the depot appeal.

Name \_\_\_\_\_

Address \_\_\_\_\_

Postcode \_\_\_\_\_ Email Address \_\_\_\_\_

Please make cheques / P.O.s payable to Manchester Transport Museum Society (MTMS)

**Thank you for your support**

Manchester Transport Museum  
Heaton Park  
Manchester  
M25 5SW



**Website**  
www.heatonparktramway.org.uk  
**Email**  
heatonparktramway@hotmail.co.uk  
**Tel**  
0161 740 1919 or 01282 436 802

Registered as a Charity: Number 505601

# Gift Aid

If you are a UK taxpayer it will be of great benefit to the Society if you will fill in the Gift Aid declaration below.

We can reclaim tax on your donation at no extra cost to you.

**I wish the Manchester Transport Museum Society Ltd to treat this payment and all future payments as Gift Aid donations until I notify you otherwise. I am a UK taxpayer.**

**Signed** \_\_\_\_\_

**Date** \_\_\_\_\_

**Please use BLOCK CAPITALS to complete this form:**

Name \_\_\_\_\_

Address \_\_\_\_\_

Postcode \_\_\_\_\_ Email Address \_\_\_\_\_

To: Mr J Valentine, MTMS, 34 Fountains Rd, Cheadle Hulme, Cheadle, Cheshire, SK8 7PY

**Please make cheques / P.O.s payable to Manchester Transport Museum Society (MTMS)**

Thank you for your support