

## Chris's Reordering Blog – Week 9 – 31 July to 4 August

You can see from the picture below that the lime screed is now in place over the whole of the floor. In the foreground to the left of the picture is the base for the font. Although it is pretty close to its original position it has been brought forward a little to make it easier to stand behind and whereas the plinth had been standing proud of the floor it will now be at the same level as the floor. There is a copper pipe inserted in the centre of the plinth for the water to drain into the soil beneath the floor as it had done originally. It



really does seem as though real progress has been made when you can look onto a level floor surface.

The good news is that it seems certain we will be completing the floor, which is a major part of the works, within the budget allocated.

The screed now needs to dry for about two weeks before any further work can be carried out pretty much anywhere inside the Church. It was

a difficult task getting the screed in place, around 14 cubic meters had to be barrowed into place and the levels are quite critical to ensure the stone flooring can be laid level over the screed. This is made all the more difficult since, not unexpectedly, there is a very slight downward slope west to east which has to be allowed for.

This photograph is of part of the plan showing the layout of the stone 'tiles' that will make up the

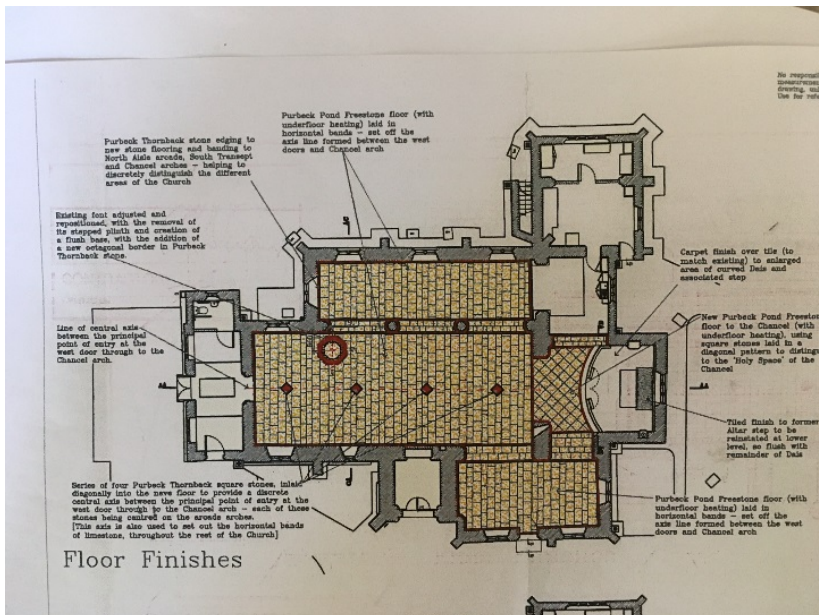

finished floor. They are 30mm (a bit over an inch) thick. The original design had almost all of these tiles uniformly the same size but it was a requirement of the faculty approval by the Diocese that the random pattern of different sized tiles was created, with a uniform north-south line. You can see also that there is a darker

stone finish around the font, the pillars and defining the different sections of the Church; Nave, North Aisle, South Transept and Chancel, as well as diamonds, in this darker colour, lining up between the West Door and The Altar. You can see also that there is a diagonal pattern in the Chancel with uniform sized tiles. It will look great, but it does make Wrencon's job a lot more difficult to lay them.

While the screed is drying over the next couple of weeks the contractor is starting work on the glass 'lantern' in the Porch ceiling that will provide additional light into the Porch and also reveal the tops of the arches on both the West Door of the Nave and the Porch outside door, but more on that next time.

*Chris Young – 9 August 2017*