

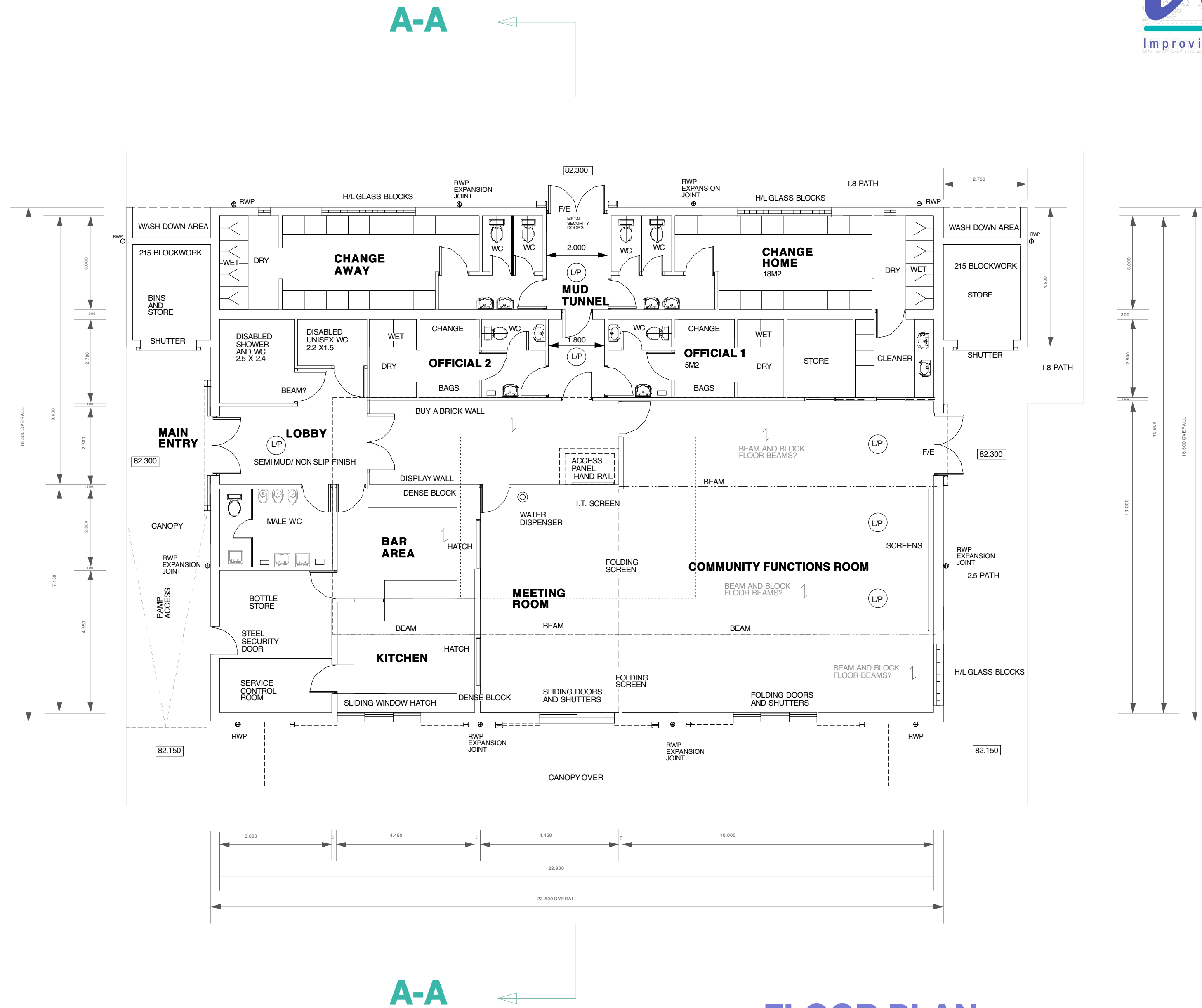

*** COMMUNITY AMENITY PROJECT JUBILEE FIELDS WEEDON BEC ***
DETAIL PROPOSED GENERAL ARRANGEMENT FLOOR PLAN



B-B

B-B

A-A

FLOOR PLAN

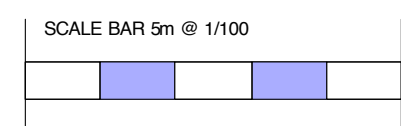

Weedon Sports Association

20 Lancers Way
 Weedon
 Northamptonshire
 NN7 4PH
 Tel: 0845 4177 635
 Email: weedonsa@aol.co.uk

Established 1993
 Registered Charity: 1026474
 Chairman: Anthony Wincott

WALKER ASSOCIATES ARCHITECTS.
 ADDRESS: GODFREY HOUSE NO 17 CHURCH STREET WEEDON NORTHANTS NN7 4PL
 TEL./FAX 01927 340310 MOBILE 0780606110 E-mail walkerarchitects@hotmail.co.uk

CHARTERED ARCHITECT: LYNNE WALKER B.A.HONS.DIP ARCH. RIBA.

THIS DRAWING IS COPY RIGHT AND MUST NOT BE REPRODUCED WITHOUT WRITTEN PERMISSION FROM WALKER ASSOCIATE ARCHITECTS. DO NOT SCALE. ALL DIMENSIONS SHOULD BE CHECKED PRIOR TO THE COMMENCEMENT OF WORKS AND ANY DISCREPANCIES REFERRED TO THE ARCHITECT IMMEDIATELY.

SCALE
DETAIL
JOB NUMBER

1/100
FLOOR PLAN
2093/P4