



At the heart of the community...

Eye & Dunsden Village Hall is a much loved centre of the local community. Built as a school in the nineteenth century, it is actively used by local groups, exercise classes, a popular kindergarten and for family parties.

The building and its attractive grounds are run by a dedicated group of volunteer trustees. However the facilities are in urgent need of modernisation. The trustees have now identified an exciting opportunity to improve the hall, enabling it to continue to serve the community for years to come. Your support is needed to turn these ambitious plans into reality.

Highlights of the plan

A wider, sun-filled main hall with a new south-facing terrace

The trustees hope to open up the hall to its attractive grounds by widening the narrow main hall with a light-filled sun-room which will lead to a new terrace. The extension will increase the seated capacity of the hall from around 60 to 100, making it more attractive for wedding receptions. A desperately needed redecoration of the main hall will also be carried out.

An accessible new entrance foyer linking both halls

The appearance and functionality of the hall will be much enhanced by the creation of an airy new foyer which will connect both halls. The new foyer will provide much improved access for disabled users, who will also have level access to the new terrace.

Much improved new kitchen for the main hall

The new kitchen will make the hall more suitable for fully catered events, which are not possible in the current cramped and outdated facilities.

New unisex lavatories

The current lavatories are insufficient in number and need updating. Disabled users in the main hall will no longer have to go outside to reach a lavatory.

A new underfloor heating system

The hall is currently heated by noisy and inefficient fan-blown units together with some dangerous wall-mounted convector heaters. These will be replaced by a new discrete underfloor system which will be ideal for all hall users, including exercise classes.

New double-glazed windows

The hall can be cold and draughty in winter. New double-glazed windows will make the hall more efficient to heat and much cosier in winter.

Secure outdoor storage facilities

In order to free up space within the hall, it is hoped to construct a small barn style storage building in the hall grounds. It will include outside lavatories for outdoor events at the hall. This new building will replace the current shed.

Better facilities for meetings

As well as an attractive new foyer and new kitchen, WiFi and other equipment will make the small hall much more attractive for meetings. These facilities will be of benefit to smaller home-based businesses in the local community, as well as to businesses in Thames Valley Park and elsewhere.

Other improvements

A hearing aid loop will be installed throughout the hall together with better signage and ergonomically efficient fittings wherever possible.

The future outlook: a transformed hall

From a financial point of view, it is hoped the improvement of Eye & Dunsden Hall will guarantee its future viability by allowing it to be more frequently rented for a much wider range of events. We are increasingly being asked to provide a more affordable location for weddings. The hall will also be more attractive for family parties, business meetings and wakes. We also hope to host more staged events which have recently been much enjoyed by hall-goers.

A brighter, warmer hall with a welcoming new entrance and an attractive, south-facing terrace will transform our hall. We hope you will help us turn these exciting plans into a reality.

Outline project plan

Phase 1: New storage barn

Phase 2: Underfloor heating, the new Toilet Block and the new Main Hall Kitchen. Including structural work on walls and elsewhere

Phase 3: Remodelling of the smaller hall (Palmer Room) creating a new entrance, store room and toilet for the disabled and replacing the unsightly and poorly insulated flat kitchen roof with a gable

Phase 4: A new lobby and porch with the current main entrance retained as a garden entrance

Phase 5: Construction of a sun-room extension to the main hall with adjoining level patio area

Note: if all the funding can be secured initially, it will be possible to combine some of these phases, with considerable savings as a result.

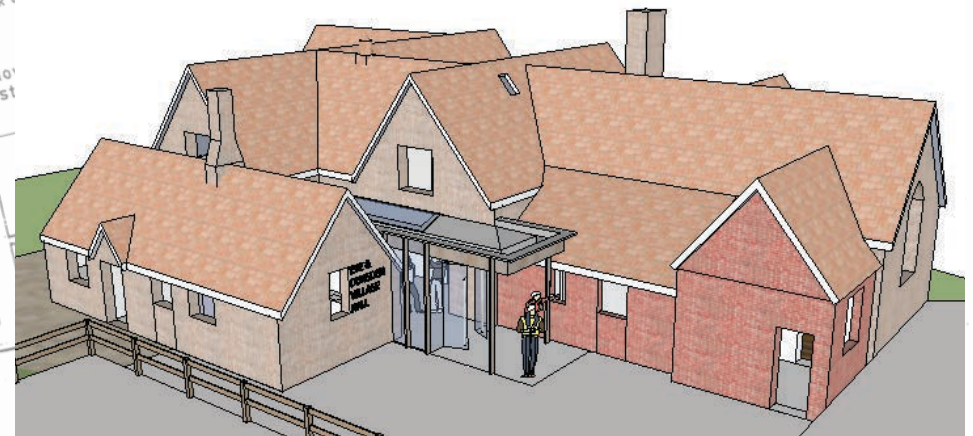



The fundraising plan

Fifty percent matching funding is potentially available from South Oxfordshire District Council

A total of **£392,500** is required for the scheme. After three years of planning, hall trustees are now approaching potential donors who can contribute to their improvement plan.

Total funding required: £392,500

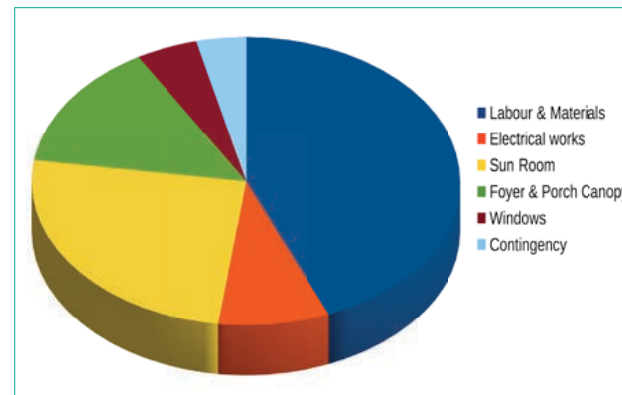

An application for **£191,000** to SODC has been successful provided we can source matching funds. We have been granted **£100,000** by a generous local charitable trust. Binfield Heath and Eye & Dunsden parish councils have also been asked to consider a donation of **£5,000** each, perhaps in the form of a specific levy on council tax bills. The hall has saved **£35,000** for the scheme. In addition, a programme of fundraising events is planned, which it is hoped will contribute around **£10,000** of the total cost.

It is hoped to make up a shortfall of around **£46,000** with donations made by local people and businesses.

Potential funding sources

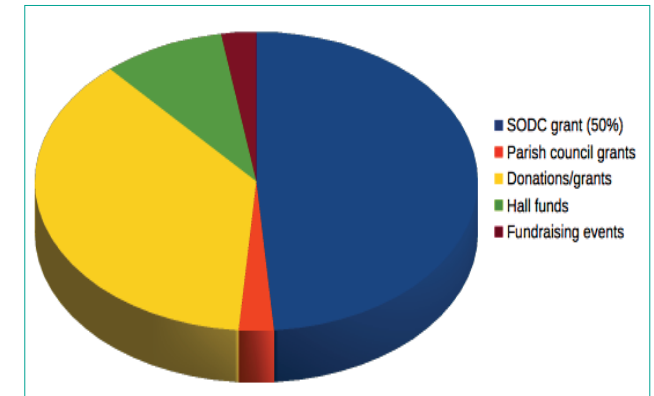

How can I help?

If you would like to contribute to the hall's transformation please contact **Beth Timms**, the Appeal Director. Telephone 01189 461987 or email dunsdenvillagehall@yahoo.co.uk. Online donations including Gift Aid are easy at mydonate.bt.com/charities/eyedunsdenvillagehall.

On request, donors will be commemorated on a special board inside the new hall.



Words and design thanks to www.designforprint.org | August 2016
Photography thanks to www.bluematrixphoto.com