

# WELCOME TO

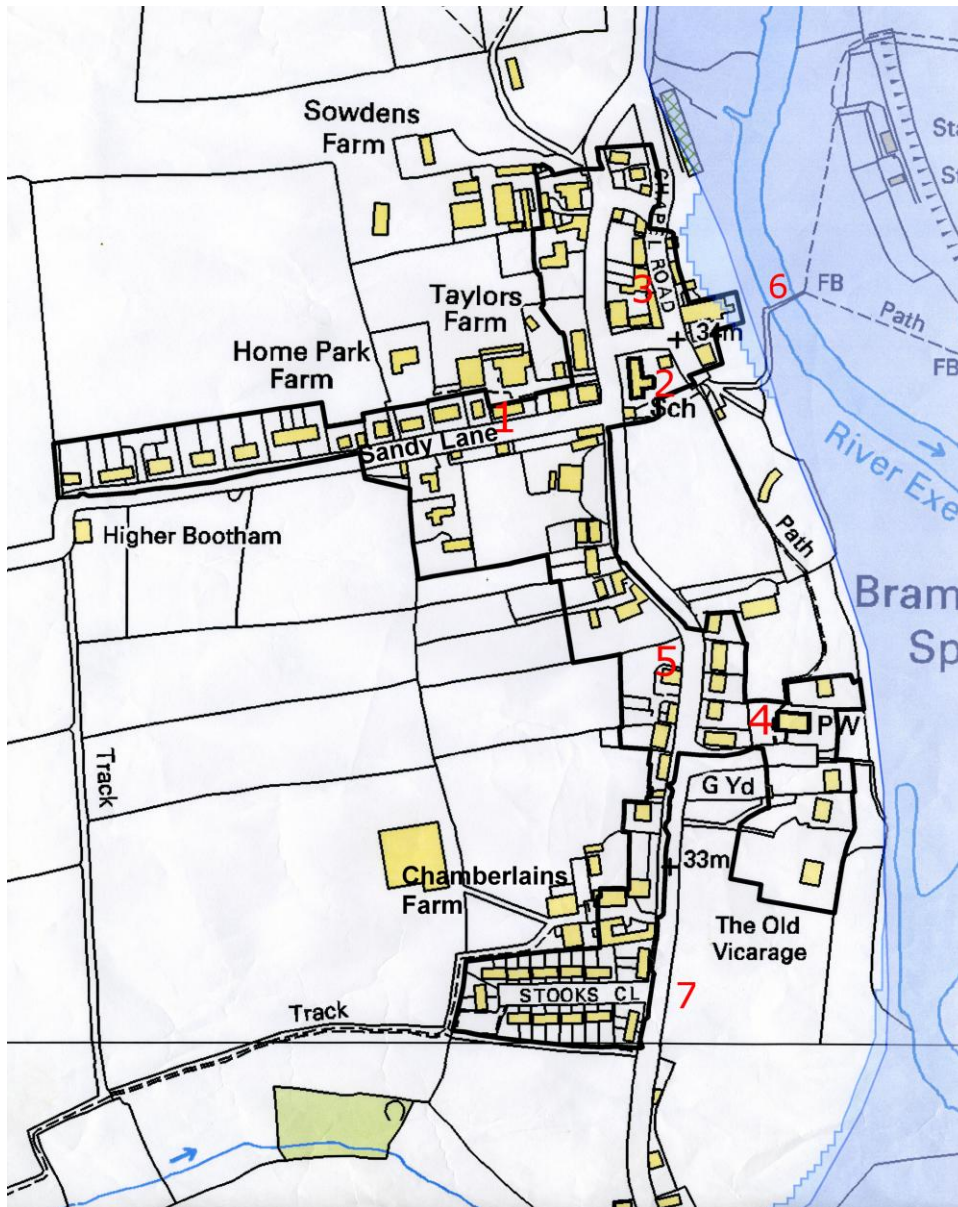

# BRAMPFORD SPEKE

## MAP OF VILLAGE SHOWING MAIN AMENITIES



<b>Key</b>	
<b>1</b>	Village Hall
<b>2</b>	School
<b>3</b>	Baptist Chapel
<b>4</b>	St Peter's Church
<b>5</b>	Public House
<b>6</b>	Footbridge over River Exe
<b>7</b>	Bus Stop

## AMENITIES

### Notice Boards

There are two: the main one is by the telephone box opposite the school, and there is another one in the bus shelter opposite Stooks Close.

### Village Hall

The Village Hall in Sandy Lane is well used for a variety of activities (see the parish magazine *Speke Up*, below). To make a booking ring Molly Luxton on 841270. Brampford Speke Village Hall Trust Chairman is Jim Franklin, Coldharbour, Brampford Speke, Exeter, Devon EX5 5HQ.

## **School**

Brampford Speke Primary is a popular and caring village school. Further information can be found in the school brochure available from the school. Please contact Nic George (Headmaster) on 841414 or e-mail [admin@brampfordspeke.devon.sch.uk](mailto:admin@brampfordspeke.devon.sch.uk).

Brampford Area Pre-school is sited within Brampford Speke C of E Primary School. It welcomes children from 3 years to school age; 2½yr-olds are welcome if accompanied by an adult. The Pre-school is open 9.00-3.30 Monday to Thursday, and 9.00-1pm Friday. For further information contact Jackie White on 841214. There is also a Baby and Toddlers Group –see page 7.

## **Worship**

St Peter's Church (C of E): Team Rector: Douglas Dettmer, 860332; see *Speke Up* for Parish Directory.

The Baptist Chapel in Chapel Road; see *Speke Up* for times of services.

## **The Pub**

Formerly The Agricultural Inn, now The Lazy Toad. Mo and Clive Walker have owned the pub since 2008, and have renovated the building substantially, creating "a cosy, beamed series of rooms on the ground floor where good food, real ale and fine wines are served from Tuesday to Sunday lunchtimes and Tuesday to Saturday evenings". The Lazy Toad is a very popular, thriving pub/restaurant, and reservations are strongly advised to guarantee a table, especially at weekends. Tel. 841591.

## **Footpaths**

Brampford Speke parish has many public footpaths (total 3.5 miles) and one bridleway (.75 miles) – see map and key on pages 4 and 5. Our footpaths offer delightful walking in unspoiled countryside, providing links with neighbouring parishes such as Upton Pyne and Stoke Canon. Part of the popular Exe Valley Way runs through the parish. Some of the meadows adjacent to the river are subject to SSSI (Site Of Special Scientific Interest) due to the meandering and constantly altering river course. Additionally, some fields/permissive footpaths within fields are open under the Countryside Stewardship Scheme (see map on page 6). Please take care to keep dogs on a lead where appropriate (especially where they may interfere with livestock), and to shut gates behind you. Devon County Council, as the Highway Authority, is ultimately responsible for the paths' maintenance, but any comments on them should be made in the first instance to the Footpath Warden (see below). **NB see pages 10, 12 and 13 regarding dog fouling and waste bins.**

**FOOTPATH MAP (White area is Bramford Speke Parish; Footpath Key see p5)**

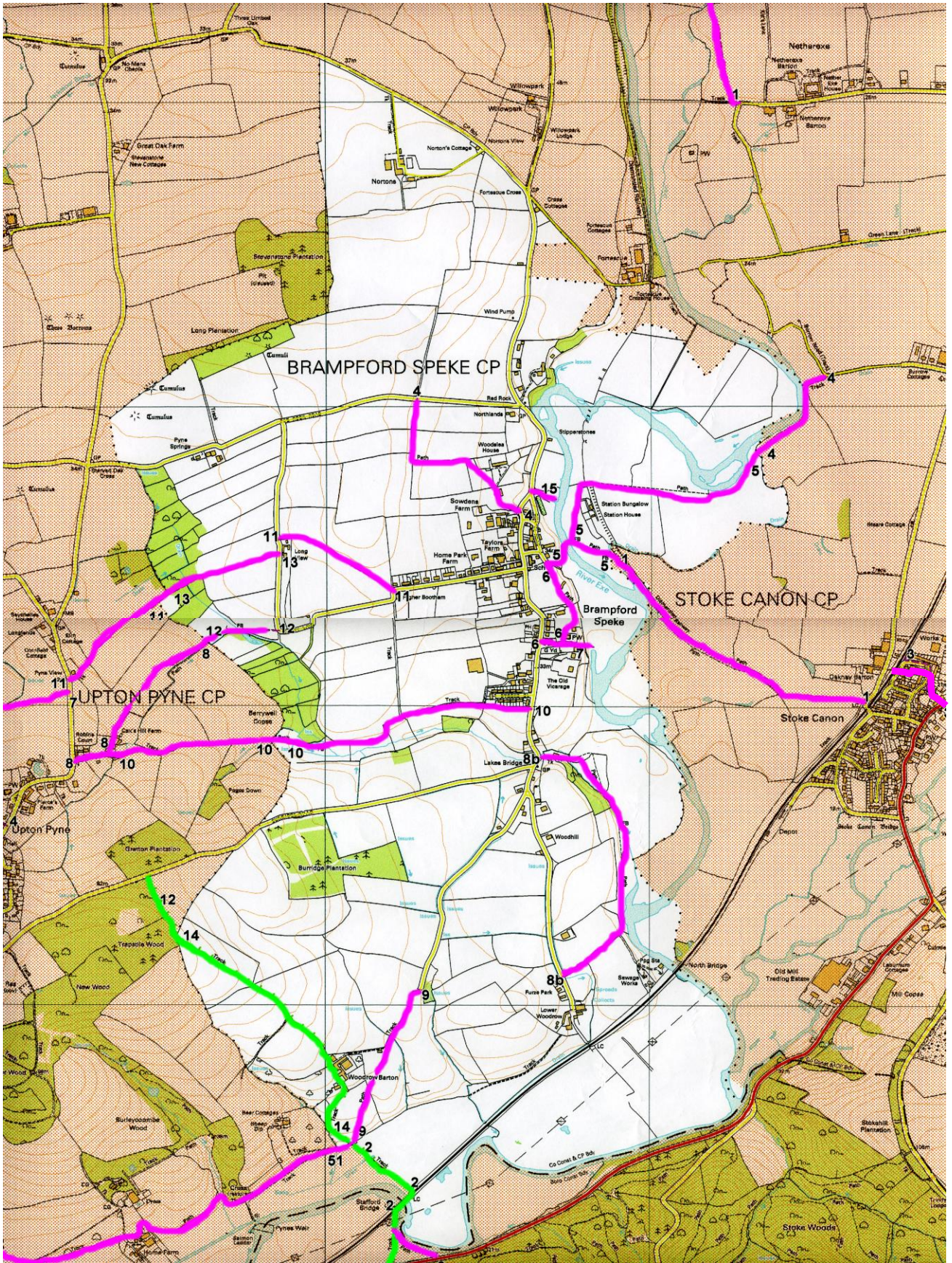

Public Bridleway  
Public Footpath

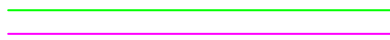

## KEY TO FOOTPATH MAP:

Footpaths are numbered on the map according to **Devon County Council Public Rights Of Way Environment Directorate**. A short description of the course of each numbered path is as follows: it is suggested that this is used in conjunction with an Ordnance Survey map – eg Explorer Series No. 114, which will give the wider context of how our parish footpaths link with neighbouring ones.

### Footpath No: Where it goes:

1. Continuation of footpath **5.** along dismantled railway to Stoke Canon.
2. Southerly continuation of public bridleway (**14.**) from south of Woodrow Barton, eventually meeting the A396 (Exeter – Tiverton road).
3. Branching southeast from the bridleway (**2**) below Stafford Bridge, meeting the A396 (Exeter – Tiverton Rd).
4. Main road near Sowdens Farm northwest to Red Rock Rd. Also (separately) a continuation of footpath **5.**; see below.
5. Opposite back of school from end of Chapel Rd down to and across river. **Left fork** goes north, then east around station buildings to edge of parish where it becomes one of the footpaths labelled **4.**, which then continues to meet Burrow Rd (track). **Right fork** crosses field to meet dismantled railway track, becoming footpath **1.** on to Stoke Canon.

TIP: A good circular walk involves using the left fork as above of footpath 5 continuing on the Burrow Rd (track) which turns right to run parallel to the A396, then following this track south until you come to the level crossing in Stoke Cannon (on your left). You turn right at that point and follow footpath 1 along the dismantled railway line; this becomes footpath 5's other fork and brings you back to the footbridge in Brampford Speke.

6. End of Chapel Rd at the back of School, running behind "The Green" – (the field opposite Brampford House) – to the church. There is another little section of footpath **6.**, running from the main road along Church Drive (between the church and graveyard), down to the "water steps" (to the right of the driveway entrance to Thyme Cottage).
7. This is the last part of the little section of footpath **6.** as it descends the "water steps" to reach the river. ("Water steps" so-called because villagers used these to collect their domestic water from the river in days gone by).
8. Main road in Upton Pyne eastward initially then northeast past Cox's Hill Farm, becoming footpath **12.** at Brampford Speke parish boundary.
- 8b. Main road at Lake Bridge, east and then south via river bending southwest to meet road north of Lower Woodrow.
9. End of road leading towards Woodrow Barton, this track continues south to meet bridleway **2.** at the parish boundary.

TIP: A good circular walk involves continuing on footpath **9.** which crosses the public bridleway becoming Upton Pyne footpath no. **51.** This path goes through a kissing gate and some woods, past Pynes House, coming out at the Pynes House entrance at the bottom of Pynes Hill. A convenient refreshment stop can then be made at Bernaville Nursery, following which the walk continues up over Pynes Hill and into Upton Pyne. The return to Brampford Speke can be made via any of the footpaths running east across the fields (**10, 8/12 or 11/13**).

10. An eastward branch-off from footpath **8.** near Cox's Hill Farm (Upton Pyne), continuing due east across to Brampford Speke, emerging onto the main road by Stooks Close.
11. Main road in Upton Pyne northwest to reach Brampford Speke parish boundary, where it becomes footpath **13.**
12. Sandy Lane eastwards becoming footpath **8.** at the parish boundary, (which then continues to Upton Pyne).
13. Sandy Lane opposite Paws-A-While west to parish boundary where it becomes footpath **11.** which continues to Upton Pyne.
14. Northwest part of the public bridleway from Woodrow Barton, meeting Burr ridge Rd opposite Gratton Plantation (The northernmost part is labelled 12).
15. Main road north of Brampford Speke village, just north of junction with Chapel Rd, east down to the river. (For the curious – this footpath exists because many years ago, the river ford used to be at this point before it was moved).

**Footpath Warden** Mike Searle, Bramleys, The Orchard, Brampford Speke,  
Exeter, Devon, EX5 5HW, Tel. 841276.

### MAP SHOWING SITE OF SPECIAL SCIENTIFIC INTEREST (SSSI)

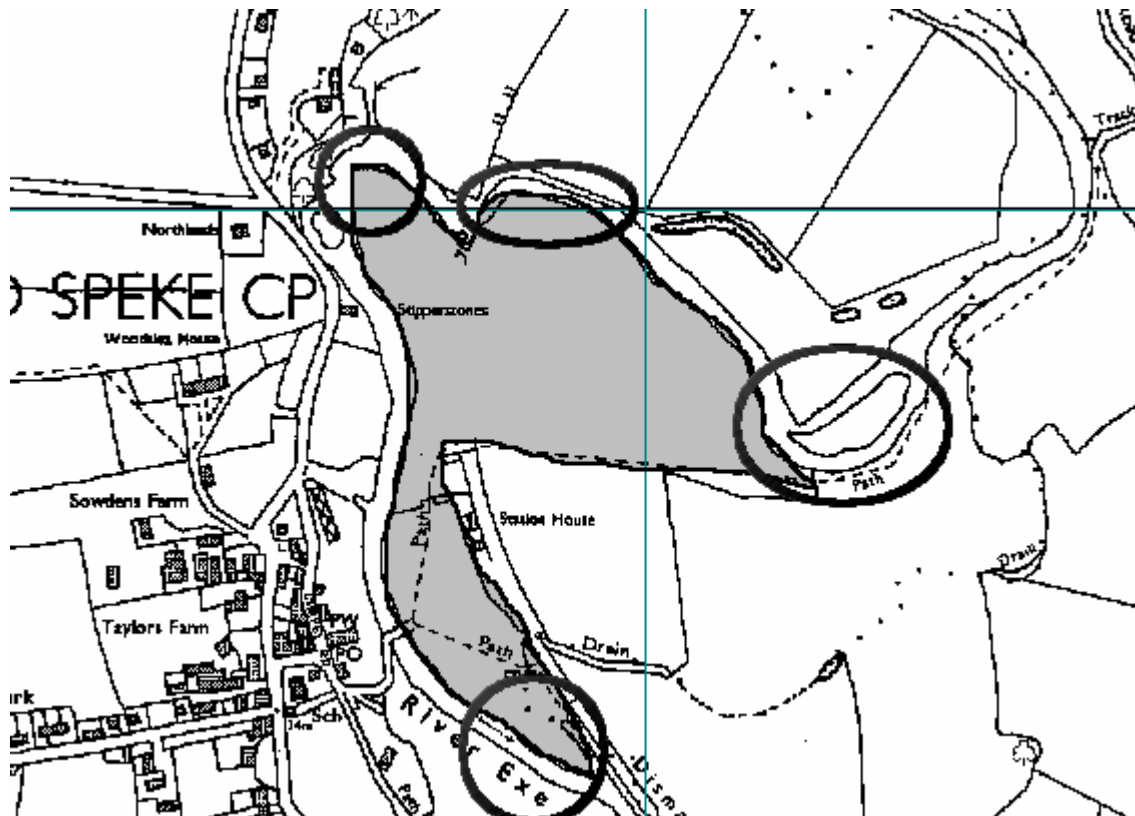

The shaded area shows the SSSI. Land in this area (at present) is open to the public via an agreement with landowners as part of the "Stewardship Scheme" – i.e. as part of a special arrangement between DEFRA and the landowners. The four circled areas are of particular geological importance in terms of the river Exe and its meandering over the floodplain. (N.B. There are also other fields and permissive footpaths in Brampford Speke Parish – especially adjacent to the river – which are covered by the Stewardship scheme but which are not part of the SSSI).

## SERVICES

### Speke Up

*Speke Up* is the parish magazine of Brampford Speke and Upton Pyne. Essential reading for local news, forthcoming events and for the adverts placed by local traders. For £2.75 a year payable in January it will be delivered to your door; contact Dave Bamford (841582).

### **Post**

We have two post boxes, both historic: in the wall in front of Chamberlain's and by the telephone box, i.e. opposite the school. The nearest Post Offices are in Stoke Canon (if on foot), otherwise Thorverton by car.

### **Telephone Box**

Opposite the school. Makes 999 calls only. The number is 01392 841262.

### **Buses**

The bus stop is opposite Stooks Close. Buses run Monday to Friday, leaving here at 10.19 (arriving at Exeter Bus Station at 10.48), and Exeter bus station (stand 5) at 13.35 (arriving at Brampford Speke at 13.59). Times are also on the Notice Boards. There is no service on Sat/Sun/Bank Holidays. Further information can be obtained from Traveledine on **08712002233**. The providers of the service are Carmel Coaches and Turners Tours (service 678).

### **Local GPs**

GP surgeries used by people living in Brampford Speke are typically one of the following:

- i) Wyndham House Surgery, Silverton, EX5 4HZ, Tel. (01392) 860034.
- ii) Newcombes Surgery, Crediton, EX17 2AR, Tel. (01363) 772263.
- iii) Exwick Health Centre, New Valley Rd, Exwick, EX4 2AD, Tel. (01392) 676600.
- iv) Exe Valley Practice, Thorverton, EX5 5NT, Tel. (01392) 860273.

### **Wyndham House Transport to Doctor Scheme**

For a small fee, you can be delivered to and collected from the Wyndham House Surgery at Silverton – book by telephoning Wyndham House on 01392 860034.

### **Link-Up Transport Scheme**

This service is provided by volunteer drivers within the village. For a small fee, vulnerable/elderly people who are unable to drive themselves or who need help of a general nature in getting to hospital or GP appointments can obtain transport and assistance. Contact Geoff Kirkwood on 840049.

### **Travelling Library**

The van from the County Library comes on alternate Mondays, outside the school from 11.55-12.55. See *Speke Up* for the dates.

### **Travelling shops / deliveries**

Milk/juice are delivered by Dairy Crest (468207). On-line/telephone orders are delivered by a number of the major supermarkets, also by some organic food suppliers.

### **Newspapers – the following are delivered to the village:**

- 1) Crediton Country Courier - (01363)774263.
- 2) Express and Echo – 667512.
- 3) Western Morning News – (01752) 765500.

### **Refuse Collection and Recycling**

Landfill waste (in the “wheelybins” provided) is collected on alternate Fridays except in weeks beginning with a Bank Holiday, when it is a day later. EDDC circulates us with timing variations, or these can be obtained on 01395 517528, or at [www.eastdevon.gov.uk](http://www.eastdevon.gov.uk).

Recycling collections are weekly on Fridays; EDDC empties both green and blue plastic boxes provided to hold certain recyclable materials listed on their pamphlet, available from the Parish Clerk. The nearest public recycling receptacles are in a lay-by on the left of Cowley Bridge Road, on the way into Exeter. As with refuse, collection is usually one day later in a week beginning with a Bank Holiday. More information can be found as above for refuse.

### **Mobile Phones**

Signal strength is often patchy on any of the networks, and reception is sometimes not possible at all in older houses with thick cob walls. On the positive side, it is generally possible to get a signal outdoors, and there does appear to be a gradual improvement year upon year.

### **Broadband**

Broadband speeds are determined by distance from the telephone exchange; Bramford Speke is relatively fortunate for a village in that despite being five miles from Exeter by road, we are only about a mile as the crow flies from our exchange at Stoke Canon. An average of three speed tests performed by the author on 26/6/11 gave a download value of 6187Kbps, and an upload value of 350Kbps.

## **CLUBS, SOCIETIES AND ACTIVITIES**

### **Baby And Toddler Group**

This meets on Thursday mornings, 9.15-11.15 in the Village Hall (term time only); contact Laura Swanton on 841127.

### **Chapel Coffee Morning**

Thursdays 10.30-11.30. See *Speke Up*.

### **Film Society**

Last Thursday evening of each month in the Village Hall, – see *Speke-Up* for details of film being shown and time (generally it is 7.30 for 8pm), or ring 840072.



### **Gardening Club**

Graham Williams in Upton Pyne, 841697. The Club brings in excellent speakers to meetings held in Upton Pyne Village Hall.

### **Pre-School Group**

This meets at the School 09.00-15.30 hrs Mon -Thur, 09.00- 13.00 hrs Fri; contact Jackie White on 841214.

### **Ramblers**

Ramblers from Brampford Speke and Upton Pyne meet regularly in Upton Pyne to drive to guided rambles as far afield as Dartmoor and Exmoor; see *Speke Up*.

### **St Peter's Week**

This is the annual occasion for a variety of social and fundraising activities centred on our Parish Church. There are two services: a Holy Communion or Evensong for St Peter's Day, and an informal Summer Festival Family Service featuring an exhibition of work by the village school. Other events often include a village auction sale, teas, a coffee morning with bring-and-buy stall, and a gift day when church council representatives sit at the entrance to Church Drive to receive donations. See *Speke Up* and door-to-door leaflets.

### **Twinning**

The village is twinned with Commes (population 390) not far from Bayeux in the French Departement of Calvados. Regular, highly successful exchanges between the villages take place (contact: Stuart Luxton, 841094).

### **Womens' Institute**

President: Molly Luxton; 841270

### **Opera Speke**

Opera Speke meets at Heron Court on the third Tuesday of the month at 7pm, screening opera productions on a large high-definition television screen with a high quality sound system. Once a year Opera Speke holds a "grand opera garden party" to raise money for charity. For further details see *Speke-Up* or ring 841770.

### **Occasional entertainments**

Bonfire Nights, Circuit Training, Line Dancing, Bingo etc. are organised by various villagers and advertised in *Speke Up*.

## **ADMINISTRATION / LOCAL GOVERNMENT**

### **BRAMPFORD SPEKE PARISH COUNCIL**

#### **Clerk:**

Debbie Trelawny                      01884 855490                      [brampfordspekepc@btinternet.com](mailto:brampfordspekepc@btinternet.com).  
Leigh Pool, Silverton, Exeter, EX5 4DA

#### **Chairman:**

Andrew Wiles                      841731                      [andrew@apwiles.co.uk](mailto:andrew@apwiles.co.uk).  
Chamberlains Cottage, Brampford Speke, Exeter, EX5 5DR

#### **Other Councillors:**

Mary Greener	840072	<a href="mailto:marygreener@outlook.com">marygreener@outlook.com</a> .
Elaine Hollingsworth	841434	<a href="mailto:elaine@stationhouse57.waitrose.com">elaine@stationhouse57.waitrose.com</a>
Stuart Luxton	841094	<a href="mailto:stuart@stuartluxton.co.uk">stuart@stuartluxton.co.uk</a>
Mac Merrett	841490	<a href="mailto:malcolm.merrett@btopenworld.com">malcolm.merrett@btopenworld.com</a> .
Mike Searle	841276	<a href="mailto:mikeandjacky@sky.com">mikeandjacky@sky.com</a> .
Richard Tillett	841268	<a href="mailto:tilletr@hotmail.co.uk">tilletr@hotmail.co.uk</a>

#### **Other useful Numbers:**

Footpath Warden: Mr M. Searle	841276
Tree Warden: Ms E. Hollingsworth	841434
Village Hall bookings: Mrs Molly Luxton	841270
Neighbourhood Watch Coordinator: Mrs Betty Cornall	841255

*If you have a matter that you wish to be considered by the Parish Council please contact the Clerk or any of the Councillors and it will be put on an Agenda. You are welcome to attend any meeting and there is a 15 minute open forum at the beginning of each when anybody can raise an issue.*

**EAST DEVON DISTRICT COUNCIL** Council Offices, Knowle, Sidmouth, Devon EX10 8HL  
01395 516551

East Devon District Councillor: Cllr D. Custance Baker 841142  
[dcustancebaker@eastdevon.gov.uk](mailto:dcustancebaker@eastdevon.gov.uk).

Dog warden, dog bins, litter bins and recycling boxes: 01395 517528

Planning: Details of planning applications are available for viewing from the Clerk or on  
[www.eastdevon.gov.uk/publicplaces](http://www.eastdevon.gov.uk/publicplaces)

**DEVON COUNTY COUNCIL** (01392) 382000

Devon County Councillor: Cllr Peter Bowden, 01404 823450  
[pbowden@eastdevon.gov.uk](mailto:pbowden@eastdevon.gov.uk).

Roads/Lights/potholes: 0845 1551004

River pollution: (Environment agency) 0800 807060

## **PLANNING AND CONSERVATION**

Brampford Speke has a number of older houses and buildings, some 'Listed' in an endeavour to protect their originality and our heritage. East Devon District Council holds a copy of the Statutory List for public inspection and this provides details on each of the listed properties. Listing protects the whole building, inside and out, and possibly also adjacent buildings if they were erected before 1<sup>st</sup> July 1948.

Guidelines on what you are/are not allowed to do and how to apply for permission before you undertake any work on the building are available from EDDC Planning Department (01395 517484, [www.eastdevon.gov.uk/planning\\_services.htm](http://www.eastdevon.gov.uk/planning_services.htm)).

### **Historic Building Grants**

English Heritage will consider making grants towards the repair of listed buildings. For more information telephone their Southwest Regional Office on 08453010007.

### **Conservation Area**

The central area of the Village is a Conservation Area (CA): 'An area of special architectural or historic interest, the character or appearance of which it is desirable to preserve or enhance.' In a CA:-

- 1 Local authorities have a duty to pay special attention to the desirability of preserving or enhancing the area.
- 2 The District Council has a duty to formulate and publish proposals for preservation and enhancing the CA. Conservation enhancement schemes are carried out by the District Council.
- 3 Planning applications may have to be taken to public enquiry.
- 4 Permitted development is more restricted than in other areas.
- 5 Demolition of certain buildings cannot be undertaken without Conservation Area Consent.
- 6 It is an offence to cut down, top, lop, up-root, wilfully damage or destroy wilfully any tree in the CA without consent of the Local Planning Authority. Fines are up to £20,000 for each tree: you are strongly advised to contact EDDC before you take action on any trees within the CA.

### **Village Design Statement**

In practice, CA regulations have had very limited success in conserving the character of the area. More powerful is the Village Design Statement (VDS) of 2003. Supported by the Parish Council and by widespread consultation with the village, it has been adopted by EDDC as Supplementary Planning Guidance. The VDS was designed to help EDDC to protect the whole village's 'natural and built environment' and will also help anyone making a local planning application. The VDS can be viewed or downloaded from the EDDC website (just enter "Bramford Speke Village Design Statement" into your internet search engine and a link will appear).

### **Parish Plan**

In addition to the VDS, Bramford Speke has a Parish Plan (PP) - designed to complement the VDS. As with the VDS, it was produced by a working group set up by, and answerable to, the Parish Council. The PP is "a declaration by local

people of how we view our village and its environment. It is an expression of public will, produced through consultation with the village". The PP involved a confidential survey of opinion of every household in the parish, which had an excellent return rate of 77%. The results of this survey both inform Parish Council policy and also have led to the creation of a number of "action groups" with specific tasks. The PP was adopted by EDDC in 2011, and can be viewed or downloaded from the EDDC website (just enter "Bramford Speke Parish Plan" into your internet search engine and a link will appear). More information about the PP can be obtained from Stuart Logan (Chair of the Working Group) on 840036.

### **Tree Preservation Orders (TPOs)**

Any tree within the Conservation Area is automatically protected by a TPO, plus other individual trees or groups of trees outside of the conservation area. Before undertaking any work on a tree, please check with the Tree Warden or East Devon District Council as to whether it is protected by a TPO.

### **Tree-Warden**

Elaine Hollingsworth, Station House, Bramford Speke, Exeter, Devon, EX5 5HF,  
Tel: 841434.

## **BONFIRES**

Please remember that bonfire smoke can be very irritating and even harmful, particularly to people with chest or heart problems, and may ruin a line full of washing or someone's enjoyment of their garden that day. Anyone lighting a fire and allowing smoke to drift across a road faces a fine of up to £2000 under the Highways (Amendment) Act 1986, and under the Environmental Protection Act 1990 it is an offence to cause a nuisance through the creation of smoke; maximum penalty £5000. Composting is a much better alternative both from the environmental point of view, and to produce excellent fertiliser for your garden. Advice on composting is available from Street Scene on 01395 517528.

IF YOU MUST LIGHT A BONFIRE, REMEMBER TO WARN YOUR NEIGHBOURS.

Non-compostable woody cuttings may be taken to any of the County Council's Civic Amenity Compounds (eg Marsh Barton or Copplestone), or the District Council's waste contractors will collect them (bagged) for a small charge; ring 01395 517528.

## **DOG FOULING AND DOG WASTE BINS**

There has been a particular problem in recent years from the small minority of people who do not clean-up after their dog, and both East Devon District Council (EDDC) and the police are committed to dealing with those responsible.

On 1/10/09 EDDC adopted Dog Control Orders for all of East Devon, under The Clean Neighbourhoods and Environment Act 2005. As a result, it is an offence not to clean-up after your dog if it fouls, and this applies to all land whether on a footpath or not. This includes all fields, verges and roads inside or outside of a speed zone. Being unaware of your dog fouling is not accepted as a defence. At present, this means an £80 fixed penalty or if appropriate the matter would be sent to the Magistrates Court where a fine of up to £1000 could be imposed. Brampford Speke Parish Council thanks all those dog owners who do clean-up after their dog, and even more so those who clean-up after others! There are two dog waste bins in the parish: 1) At the top of the path leading down to the bridge over the river and 2) Attached to a telegraph pole just outside of the road which leads into the church (Church Drive).

## **SECURITY**

### **Police**

In an emergency always ring 999. Neighbourhood Beat Manager is PC Keith Bradshaw and Community Support Officer is PCSO Lisa Crocker. To leave a message ring 08452 777444, or e-mail:

[Lisa.CROCKER@devonandcornwall.pnn.police.uk](mailto:Lisa.CROCKER@devonandcornwall.pnn.police.uk) .

[Keith.BRADSHAW@devonandcornwall.pnn.police.uk](mailto:Keith.BRADSHAW@devonandcornwall.pnn.police.uk)

### **Neighbourhood Watch**

Brampford Speke has an active Neighbourhood Watch scheme. Our Neighbourhood Watch Coordinator, Mrs Betty Cornall (841255) receives information from the rest of the community on anything unusual or suspicious, and passes it to the police. The idea is to reduce the local opportunity for crime. If no reply on 841255, please ring 08452 777444.

### **Traffic Problems**

Various traffic calming measures have proved impracticable (e.g. because of farm machinery). The Parish Council has succeeded in lowering the speed limit in the village to 20 mph. Please:

- keep your speed to 20mph throughout the village (BY LAW)
- watch out for children and animals in the road
- park away from junctions and field gates (tractors and trailers need lots of turning room)
- leave room for emergency vehicles
- The police will deal with any vehicle causing an obstruction if it is reported to them.

The Parish Council is happy to receive suggestions for traffic management.

**Produced by John Eggleton on behalf of Brampford Speke Parish Council,**

**Sept 2011.**